



WEATHERPROOF IP HORN LOUDSPEAKER

APH30-IP

The APH30-IP is a 20 Watts IP horn loudspeaker for voice, paging, intercom, music streaming, audio routing, pre-recorded and scheduled announcement, VoIP communication or as the SIP endpoint where network-wide communication is desired and high-output loudspeakers are required to overcome high ambient noise and/or large spaces.

The APH30-IP incorporates 3 control inputs for level control and source selection (using the RAC 5/8 controllers), 1 contact output for triggering events.

To configure, control, monitor the IP speakers in real-time, this can be easily done through your favorite web browser interface, making the management even the most complex environments simpler than ever.



● Features	
Support PoE+ and/or connect to 24 VDC power adapter (if PoE+ is not available)	
Cost effective and simple installation with single cable deployment	
Easily configured, controlled, managed and monitored via web browser	
IP based for music streaming, routing, paging and control over LAV/WAN	
Full DSP includes AEC, NR, Ducker, AGC, PEQ, Hi/Low Pass, Compressor, Limiter, etc.	
3 control inputs for level control and source selection using the RAC 5/8 controller	
1 relay contact output	
Network audio codec: G.711, G.722, WAV, mp3	
3rd party control with TERRACOM system	
Support VoIP call via SIP protocol	
● Certifications	
	EN 55032, EN 55035, EN 61000-3-2, EN 61000-3-3
● Electrical	
Rated power, Watts	20
Effective Frequency Range, Hz (BSEN60268-5)	340-16,000
S.P.L. @ 1 m, 1 Watt, dB, Octave, 100 Hz-10 kHz	108
S.P.L. @ 1 m, Full power, dB, Octave, 100 Hz-10 kHz	122
Dispersion at 1k/2k Hz, Degrees	105/49 Horizontal 142/68 Vertical
Power supply	PoE+, IEEE802.3af, class 3 DC power input: 24 VDC (18-24 VDC) Minimum power supply: 2 A



ATEIS Europe B.V.
Celsiusstraat 1 - 2652 XN Lansingerland (Rotterdam Region), Netherlands
Tel: +31 (0)10 2088690, www.ateis-europe.com, info.eu@ateis.global





APH30-IP

● Control Inputs	
Type	Euro-block terminal
Mode (analog/TTL), VDC	max. 3.3
TTL logic input (max.), VDC	HIGH active: 3.3 LOW active: 1.2
● Interconnection	
Female RJ45 socket, CAT5/6 cables	
Max. cable length, m	100
● Supported Protocols	
SIP 2.0 (peer and proxy)	
IETF SIP (RFC3261)	
IETF IGMP version 2 (RFC2236)	
IETF RTP (RFC1889)	
● Contact Output	
Type	Euro-block terminal
Default status	OPEN (N.O.)
Maximum voltage, VDC	100
Maximum current, A	0.5 A
● Audio	
Audio compression	G.711, G.722, WAV, mp3
● Network	
10/100 Mbps Base TX Ethernet RJ45	
Manual or Dynamic Host Configuration Protocol (DHCP) IP address setup	
Time and date synchronization using NTP	
● Environmental	
IP-rating	66
Min/Max amb temp	-25°C to 70°C
Relative humidity	≤95%
● Mechanical	
Dimensions, WxHxD mm	258 x 180 x 280
Net weight, kg	2.53
Colour (Unless Specified)	Grey, RAL7035
Material	UL-94V0 Plastic, UV resistant
Mounting	Stainless Steel U bracket and hardware



ATEIS Europe B.V.
 Celsiusstraat 1 - 2652 XN Lansingerland (Rotterdam Region), Netherlands
 Tel: +31 (0)10 2088690, www.ateis-europe.com, info.eu@ateis.global



INSTALLATION GUIDE

APH30-IP

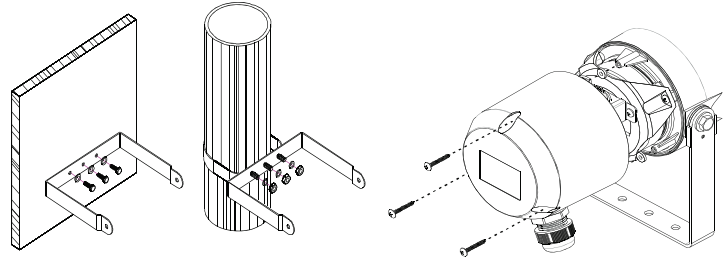
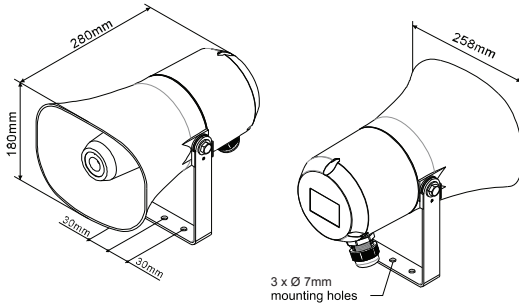

1) Remove the "U" bracket from the speaker. Align the bracket and mark the fixing points. Fix the bracket using suitable fixings (Not supplied).

2) Remove the back lid of the horn.

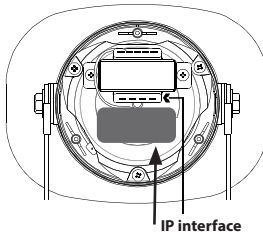

3) Connect cables to the speaker.
4) Around the inner section of the chamber where the back lid was removed a rubber gasket is located; please make sure that it is in place when re-fitting the back lid to avoid water penetration. There is a fibreglass sleeve covering the central mounting bolt, it is important that this cover is used as it protects the transformer.

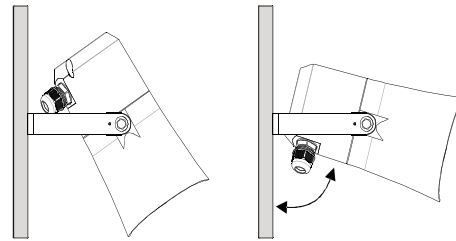

5) Re-fit the speaker to the "U" bracket. Position the speaker to the desired angle then tighten the fixings to secure in place.

SPEAKER CONNECTIONS



- 1. Speaker connection - 1 channel 20 W
- 2. RJ45 connector Ethernet
- 3. 24 VDC power input

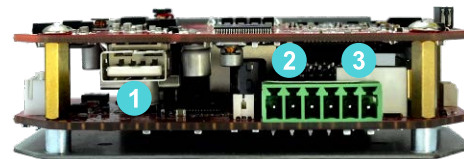

- 1. USB interface (function reserved - Not available)
- 2. 3 logic control inputs
- 3. 1 contact output

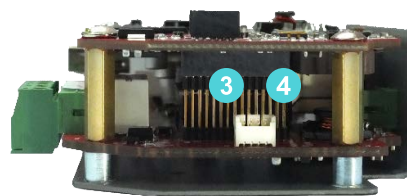
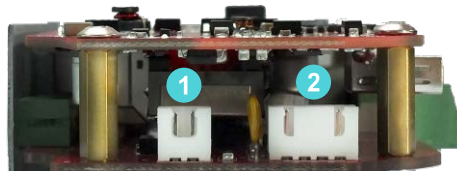

- 1. LED strobe light interface (function reserved - Not available)
- 2. RS232 interface (function reserved - Not available)
- 3. Power LED interface (+ -)
- 4. Status LED interface (+ -)

FUNCTION BLOCK

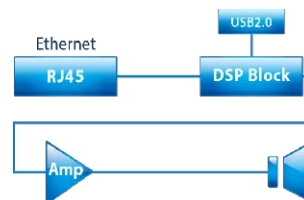

Disclaimer: We reserve the right of changes and errors.



ATEIS Europe B.V.
Celsiusstraat 1 - 2652 XN Lansingerland (Rotterdam Region), Netherlands
Tel: +31 (0)10 2088690, www.ateis-europe.com, info.eu@ateis.global

